



Mountain View
Whisman
School District

Stevenson and Theuerkauf Community Meeting

October 7, 2020

Plans are also available for viewing at
<https://www.mvwsd.org/construction>

Guiding Principles

Goal 5 Resource Stewardship

- Goal 5: Students, staff and community members will have access to various resources, such as technology, facilities, furniture, equipment, etc., in a fiscally responsible manner, to fulfill the mission of MVWSD.

Guiding Information

- Safety of students and staff
 - Feedback during the Master Facility Planning as well as the [Safety Town Hall](#) (April 2018)
- Sharing district fields and playgrounds
 - Partnership with the community is valued
 - Both residents and City leagues/events



Mountain View
Whisman
School District

What Is the Need?

Safety

- Securing our campuses to deter school violence and protect students and staff was a priority with the community (From the Safety Town Hall in 2018).
- Fences as well as cameras were listed in the Master Facility Plan as a priority 1 need. The MFP was approved on December 12, 2019.
- While fences and security cameras will not stop someone who is determined to hurt children and staff they are deterrents.
- It stops individuals from walking onto campuses during school hours. Helps prevent dog bites on campus.

COVID 19 Impact

- On Friday March 13, 2020 MVWSD announced that students would not be returning to campus on March 18th due to COVID-19.
- For COVID safety, required to limit contact between the public and students/staff during school hours if students return to school with specific entry and exit points that can be monitored.
 - Per County and State guidelines



Mountain View
Whisman
School District

Current Plans

Current Design

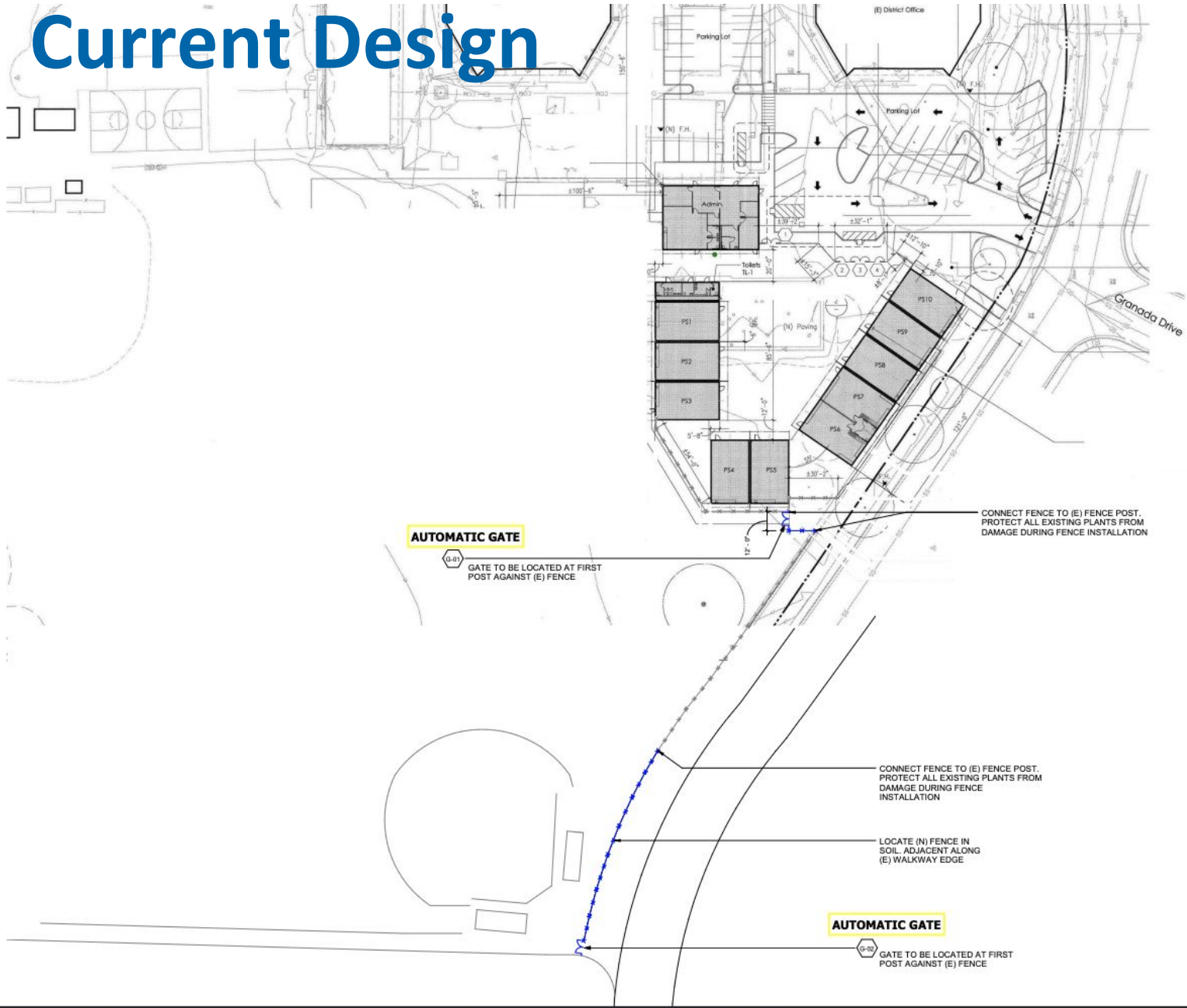

Access through automatically opening locks



- Gates with automatic locks would unlock after children are out of school and remain unlocked on the weekends.
- The intent is to allow community access when students are not in school.
- Gates will be unlocked during after school programs.

Field Access Times

- To ensure that our campus is secure prior to the start of school and as we release our students at the end of the day, the fields will be accessible
 - Monday-Friday
 - Before school begins and after school is dismissed
 - Weekends

Stevenson Park Example



Mountain View Whisman School District



Mountain View
Whisman
School District

Where We Are Now

Process and Timeline

- Laws regarding public works and approval needed from the Division of State Architect (DSA) impacted the process the District would have gone through given the time sensitivity of the project.
- Over the summer the District held multiple Focus Groups with parents and staff, Task Force meetings, and conducted a Thoughtexchange to get feedback from every parent and staff member in the district.
- These meetings informed the District's speed at which we needed to move with the perimeter controls.
- We anticipate construction to begin in late October and finish in January

School and City Involvement

- Feedback from school principals was incorporated after site walks and two or three conceptual options were considered.
- MVWSD communicated with the City about potential perimeter controls as soon as it was determined what was needed. Conceptual drawings were then sent for feedback and adjustments made based on access needs.
- Contracts for Greystone and HY Architecture were taken to the school Board.

What is Ornamental Fencing?



Chain Link vs. Ornamental



Mountain View Whisman School District

Questions

- How can we address access issues after hours?
- Is there anything we should consider that we may not be aware of?



Mountain View
Whisman
School District

Questions and Discussion